

additional connections were proposed to increase connectivity within a 5-minute walk of the town center

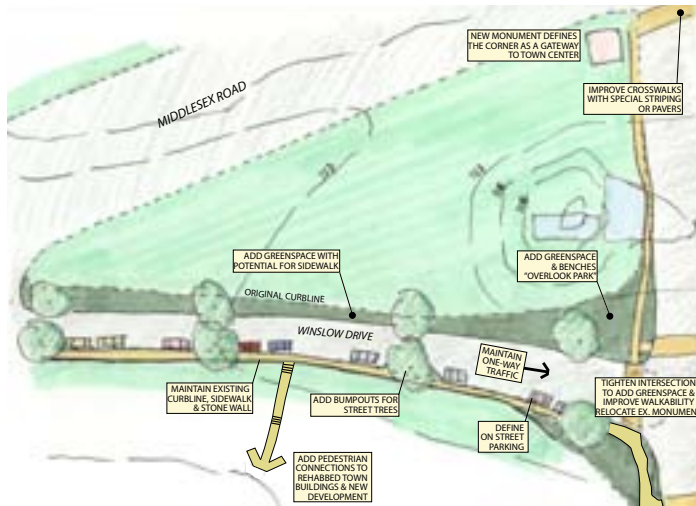

the existing oversized Winslow Drive was re-envisioned as a pedestrian friendly shared street - inviting visitors to venture into the Town Center

Client:

Town of Tyngsborough

Status:

Unanimous Economic Development Committee approval

Working with existing underutilized town centers presents unique infrastructure challenges. In Tyngsborough, recommendations focused on short, medium, and long-term action items to economically improve walkability, safety, parking, & open space within the Town Center.

As part of the follow up to the Town Master Plan, the Town of Tyngsborough commissioned a planning and design study to create a Master Plan combining land use, economic development, and community objectives into a vision for a vibrant town center.

Working with Concord Square Development and the Town of Tyngsborough, Morris Beacon Design was responsible for research and mapping of existing conditions, conducting public outreach and synthesizing stakeholder input, producing design vision scenario drawings and sketches at workshops and in the studio, and providing recommendations related to infrastructure, streetscape, open space, and parking.

Recommendations included travel way reductions and the addition of on-street parking within the study area to increase walkability and improve safety, the addition of appropriately designed parking on town-owned land, the addition of a new road link to improve access to town-owned land, strategic addition of small scale green "moments" to link to existing public space, and additional definition of existing public spaces.